



Primelite Manufacturing Corp

407 S Main St, Freeport, NY 11520

Phone: 516-868-4411 | Fax: 516-868-4609
 sales@primelite-mfg.com | www.primelite-mfg.com

PART # #38/850 ESW	LAMP E26 Socket	VOLTAGE 120 V	COLOR Powder Coated Paint
JOB NAME			TYPE Gooseneck

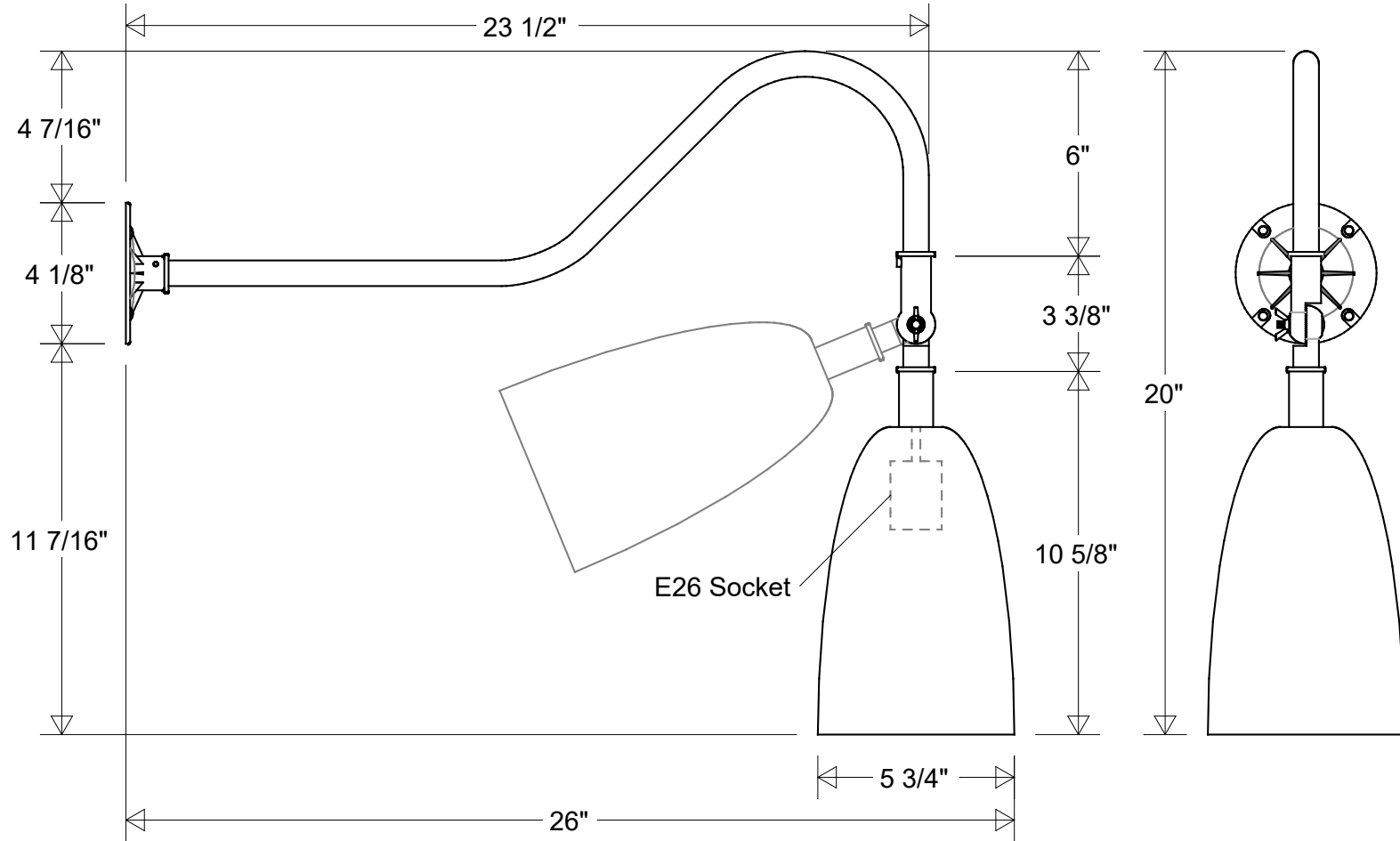

Lamp: E26 Socket Max Wattage: 150 W	Initials	Date	#38/850 ESW		<table border="1"> <thead> <tr> <th colspan="5">Revisions</th> </tr> <tr> <th>Zone</th> <th>Rev</th> <th>Description</th> <th>Date</th> <th>Appr</th> </tr> </thead> <tbody> <tr><td> </td><td> </td><td> </td><td> </td><td> </td></tr> <tr><td> </td><td> </td><td> </td><td> </td><td> </td></tr> <tr><td> </td><td> </td><td> </td><td> </td><td> </td></tr> </tbody> </table>					Revisions					Zone	Rev	Description	Date	Appr															
	Revisions																																	
	Zone	Rev	Description	Date	Appr																													
Drawn	CB	04/2023	5 3/4" Dia 26" Ext 20" H																															
Checked			6" Drop 11 17/16" Below Box																															
ENG Appr.																																		
Construction: Aluminum	MFR Appr.		Size	Drawing No.	Rev																													
	QA		A	0001	A																													
Unless Otherwise Specified: Dimensions in Inches	Weight:		Scale	CAD File	Sheet	1 of 1																												